

PARCEL MAP

OF A PORTION OF THE NE 1/4 OF THE SW 1/4 OF SECTION 14, T.13 N, R.9 W, M.D.B. & M, PER DOC.#2005-035563 OFFICIAL RECORDS, COUNTY OF LAKE, CALIFORNIA P.M. 06-29.

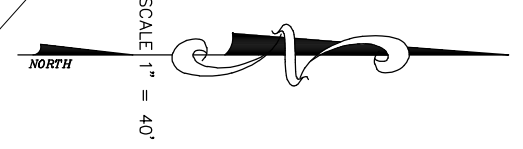

Richard A. Barber
RICHARD A. BARBER, DUKE L.S. 7588

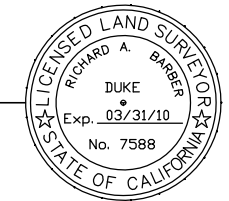

RUZICKA ASSOCIATES
CONSULTING ENGINEERS
CIVIL ENGINEERING PLANNING SURVEYING
P.O. BOX 1189 2495 PARALLEL DRIVE
LAKEPORT CA. 95453 (707) 263-6155
FAX (707) 263-0788